

# ER32 Collet Grip Dimensions

Contributed by: Andrew Kott

A.K.A "Andrew\_K99"



[www.penturners.org](http://www.penturners.org)

This tutorial was downloaded from

<http://www.penturners.org>

The International Association of Penturners - 2013

# ER32 Collet Grip Dimensions

Compiled by Andrew Kott AKA Andrew\_K99

[The following table was compiled from \(Precision ER32 Collets\).](#)

It shows the metric and fractional collets listed separate to make it easier to see the overlap in clamping ranges. Notice how the metric collets just cover the full clamping range where there is overlap with the fractional collets.

Each ER32 collet has a range of .039 inches(1mm).

The Nominal Size indicated on the collet is the largest size it can hold. It can be collapsed to the smaller clamping range listed.

For example, ER32-1/4 can hold a round shank from .250 diameter down to .211 diameter.

## Fractional ER32 Collets

Nominal Size	Decimal	Clamping Range
3/32"	0.093"	0.093"-0.054"
1/8"	0.125"	0.125"-0.086"
5/32"	0.156"	0.156"-0.117"
3/16"	0.187"	0.187"-0.148"
7/32"	0.218"	0.218"-0.179"
1/4"	0.250"	0.250"-0.211"
9/32"	0.281"	0.281"-0.242"
5/16"	0.312"	0.312"-0.273"
11/32"	0.343"	0.343"-0.304"
3/8"	0.375"	0.375"-0.336"
13/32"	0.406"	0.406"-0.367"
7/16"	0.437"	0.437"-0.398"
15/32"	0.468"	0.468"-0.429"
1/2"	0.500"	0.500"-0.461"
17/32"	0.531"	0.531"-0.492"
9/16"	0.563"	0.562"-0.523"
19/32"	0.594"	0.593"-0.554"
5/8"	0.625"	0.625"-0.586"
21/32"	0.656"	0.656"-0.617"
11/16"	0.688"	0.687"-0.648"
23/32"	0.719"	0.718"-0.679"
3/4"	0.750"	0.750"-0.711"
25/32"	0.781"	0.781"-0.742"
13/16"	0.813"	0.813"-0.783"

## Metric ER32 Collets

Nominal Size	Decimal	Clamping Range
3.0 mm	0.118"	0.118"-0.079"
4.0 mm	0.157"	0.157"-0.118"
5.0 mm	0.196"	0.196"-0.157"
6.0 mm	0.236"	0.236"-0.197"
7.0 mm	0.275"	0.275"-0.236"
8.0 mm	0.315"	0.315"-0.276"
9.0 mm	0.354"	0.354"-0.315"
10.0 mm	0.393"	0.393"-0.354"
11.0 mm	0.433"	0.433"-0.394"
12.0 mm	0.472"	0.472"-0.433"
13.0 mm	0.511"	0.511"-0.472"
14.0 mm	0.551"	0.551"-0.512"
15.0 mm	0.591"	0.590"-0.551"
16.0 mm	0.630"	0.630"-0.591"
17.0 mm	0.670"	0.669"-0.630"
18.0 mm	0.709"	0.708"-0.669"
19.0 mm	0.749"	0.748"-0.709"
20.0 mm	0.788"	0.787"-0.748"

ER32 Collet Dimensions.

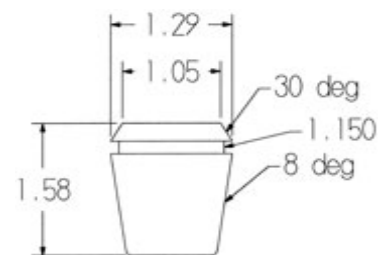

For a good discussion on collet and chuck usage see:

[http://content.penturners.org/library/tools\\_and\\_jigs/colletchuckusage.pdf](http://content.penturners.org/library/tools_and_jigs/colletchuckusage.pdf)